

RIDA®QUICK Calprotectin

Quantitative rapid test with the most extensive measuring range for fecal calprotectin

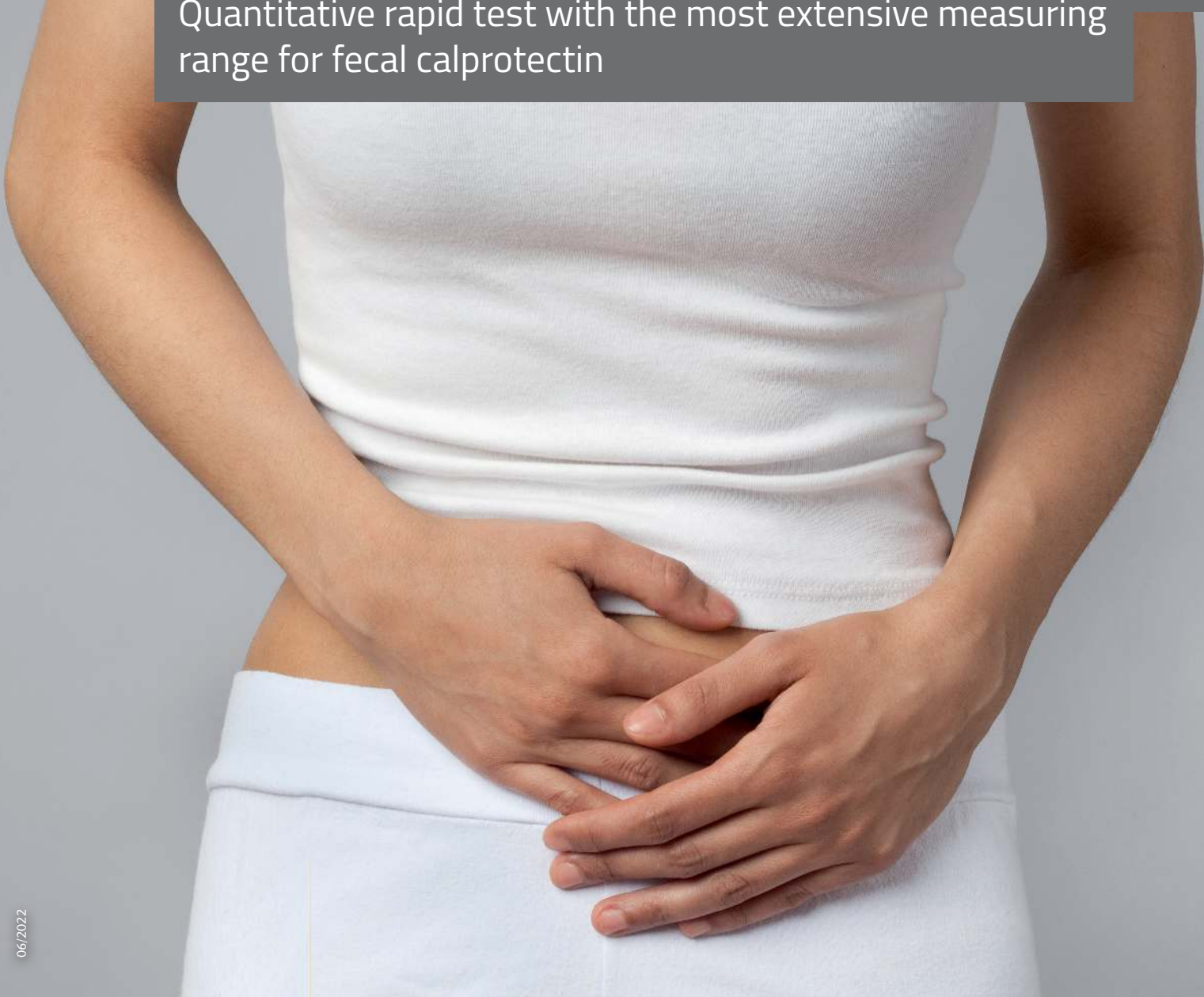

06/2022



Quantitative results



Extended measuring range



RIDA®TUBE included

More information:



<https://r-b.io/11>

RIDA®QUICK Calprotectin

Art. No. GN3037

RIDA®QUICK Calprotectin allows not only the identification of IBD patients, but thanks to its extensive measuring range, now up to

2,100 mg/kg, permits also a precise monitoring of the IBD patient's clinical course in order to adapt the therapeutic approach.

RIDA®QUICK Calprotectin: ready-to-use preanalytical fecal extraction device

Calprotectin is extracted from human stool samples using the dedicated RIDA®QUICK Calprotectin Tube. RIDA®QUICK Calprotectin is a ready-to-use preanalytical device, already included in the kit. The length of RIDA®QUICK Calprotectin Tube

collection stick avoids contamination, while the diagonal grooves allow to work with all kind of sample consistencies. After a fast and easy extraction protocol, the fecal extract has to be diluted and pipetted into the test cassette.

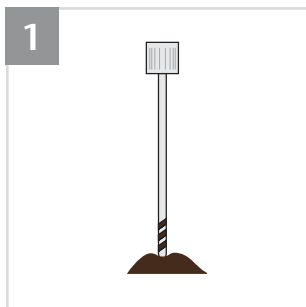

1 Collection of fecal specimen with the stick.

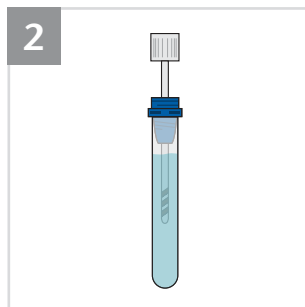

2 Insertion of the stick into the tube through the filtering funnel.

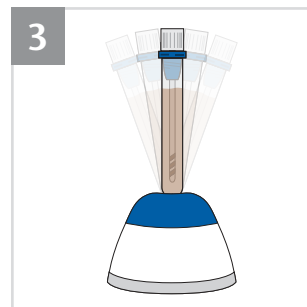

3 Vortexing for 30 - 60 seconds.

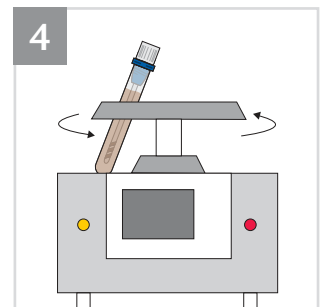

4 Removal of the stick and funnel and centrifugation for 10 minutes or left to sediment for 20 minutes.



RIDA®QUICK SCAN II Reader

After a 20 minutes incubation time, calprotectin concentration can be determined by analyzing RIDA®QUICK Calprotectin test cassette with the dedicated RIDA®QUICK SCAN II reader.

Interpretation of results

Calprotectin cut-off values from fecal specimens for the identification of IBD patients:

Calprotectin concentration	Interpretation	Follow-up
< 70 mg/kg	Normal	None
70- 140 mg/kg	Borderline	Re-evaluation
> 140 mg/kg	Abnormal	Further clinical investigations required

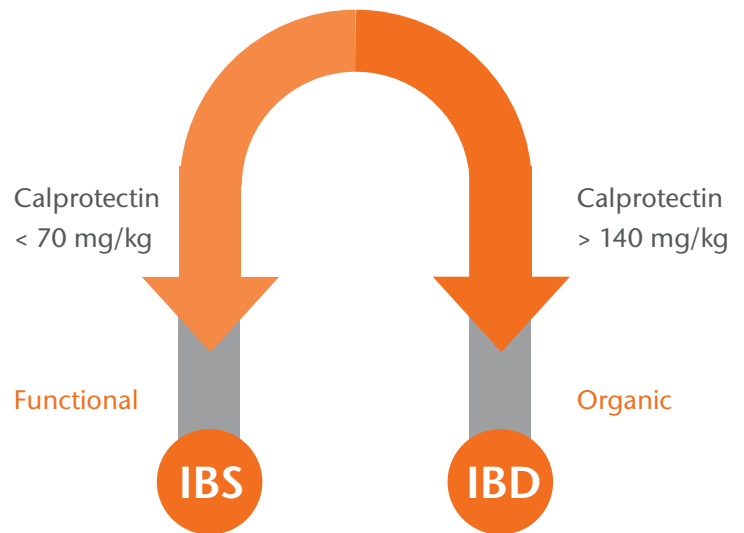

Performance

The clinical performance of the RIDA®QUICK Calprotectin test was tested in a study with a total of 81 patient samples. Forty-two patients were diagnosed with Crohn's disease, ulcerative colitis, or microscopic colitis. The positive result was diagnosed based on clinical findings and/or confirmed by colonoscopy.

The 39 negative samples came from patients with irritable bowel syndrome, recurring stomach pain, and other diseases.

Assessment of samples in the detection limit as negative

RIDA®QUICK Calprotectin (Cut-off = 140 mg/kg)			Clinical diagnosis
Total	Positive	Negative	
42	40	2	IBD
39	4	35	Not IBD
81	44	37	Total
Sensitivity		95,2 %	95 % CI* (84,2 % - 98,7 %)
Specificity		89,7 %	95 % CI* (76,4 % - 95,9 %)

* CI = confidence interval (Mercaldo-Wald)

Kit content

- 20 test cassettes
- 20 RIDA®QUICK Calprotectin Tube
- 20 RIDA®QUICK Calprotectin Caps
- Ready-to-use dilution buffer
- Negative and positive controls



Order information

Therapeutic drug monitoring (TDM)

Product	Tests	Art. No.
Rapid tests		
RIDA®QUICK Calprotectin	20	GN3037
RIDA®QUICK IFX Monitoring	25	GN3041
RIDA®QUICK ADM Monitoring	25	GN3043
Control sets for RIDA®QUICK		
RIDA®QUICK IFX Monitoring Control Set	–	GP3041
RIDA®QUICK ADM Monitoring Control Set	–	GP3043

Belonging automation solutions

Product	Art. No.
Rapid tests	
RIDA®QUICK SCAN II	ZRQS2-KD



For further details and information visit our website, contact your local distributor or Clinical Sales International.

R-Biopharm contacts:

Order Department:

Phone: +49 (0) 61 51 - 81 02-0

Fax: +49 (0) 61 51 - 81 02-20

E-mail: orders@r-biopharm.de

Clinical Sales International:

Phone: +49 (0) 61 51 - 81 02-0

Fax: +49 (0) 61 51 - 81 02-688

E-mail: clinical.sales@r-biopharm.de